

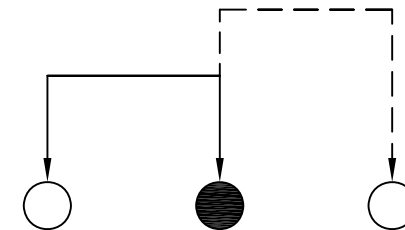

CAD FILE:

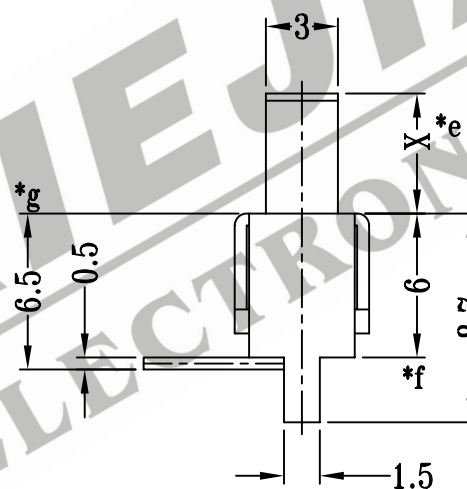

SCHEMATIC (NON-SHORTING)

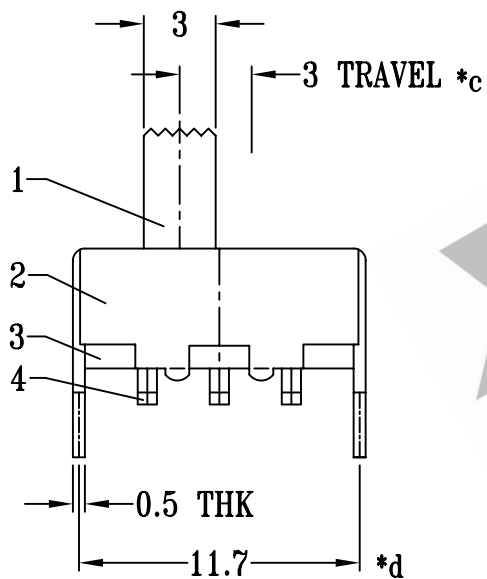
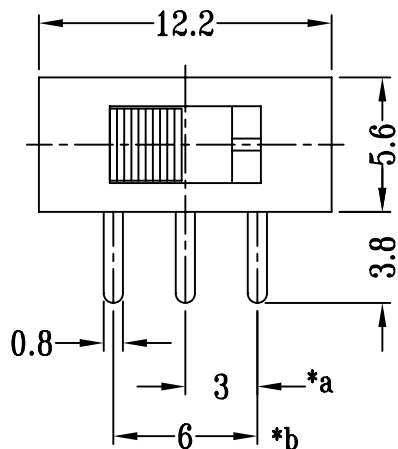
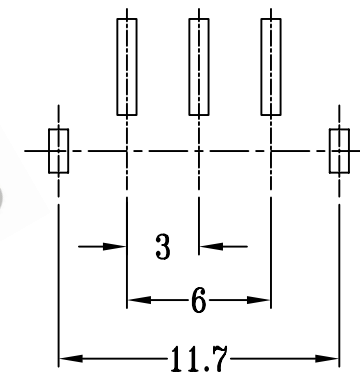

P.C.B LAYOUT

注:带“\*”表示关键尺寸(7个)

|     |              |                |      |                          |   |                                      |              |                            |           |          |  |
|-----|--------------|----------------|------|--------------------------|---|--------------------------------------|--------------|----------------------------|-----------|----------|--|
| 8   |              |                |      |                          | TOLERANCE<br>UNLESS SPECIFIED           | SHENZHEN XIEJIA ELECTRONICS CO.,LTD. |              |                            |           |          |  |
| 7   |              |                |      |                          |   |                                      |              |                            |           |          |  |
| 6   | SPRING       | STEEL WIRE     | 1    | TEMPER                   | WITHIN: 1.5±0.1mm<br>OVER : 1.5±0.2mm   |                                      |              | DESCRIPTIONS OF REVISION   |           | APPD.    |  |
| 5   | CONTACT CLIP | COPPER STRIP   | 1    | Ag PLATED                |   | ISSUE                                | DATE         |                            |           |          |  |
| 4   | TERMINAL     | BRASS STRIP    | 3    | Ag PLATED OVER Ni PLATED | TITLE : VERTICAL SLIDE SWITCH           |                                      | UNIT : mm    | DRWG NO.: XJ-DR-SS12F39-00 |           |          |  |
| 3   | BASE         | PHENOLIC RESIN | 1    | NATURAL                  | MODEL: SS-12F39                         |                                      | SCALE: 3 : 1 | DWN.                       | ZHOUYU    | 2003-4-5 |  |
| 2   | FRAME        | STEEL STRIP    | 1    | Ni PLATED                |   |                                      |              | CHK'D                      | FANGYING  | 2003-4-5 |  |
| 1   | KNOB         | POM            | 1    | BLACK                    |   |                                      |              | APPD.                      | KANGXINAN | 2003-4-5 |  |
| NO. | PARTS        | MATERIALS      | Q'TY | FINISH                   | ALL MATERIALS MUST BE COMPLIANT TO ROHS |                                      |              |                            |           |          |  |